

#10 CAM LOCK (x16)    #10 SCREW CAP (x6)    #6x34 PHILLIPS SCREW (x3)    #6x12 PAN SCREW (x6)

BOLT (x16)    GLIDE (x4)    #6x158 PHILLIPS SCREW (x6)    38 FELT (12FT)    U CHANNEL (6 FT)

AK0312 (x1)    AK0313 (x1)    AK0314 (x1)

BT10C (x3)    SS27CD (x3)

B    BT8C (x3)    A

RIGHT SIDE PANEL (x1)

LEFT SIDE PANEL (x1)

C

TOE KICK (x2)

D

BOTTOM PANEL (x1)

E

DOOR (x2)

F

FRONT GLASS (x1)

G

TOP GLASS (x1)

H

8" GLASS SHELF (x1)

I

10" GLASS SHELF (x1)

## FULL VISION SHOW CASE ASSEMBLY INSTRUCTIONS



DAWSON JONES  
STORE FIXTURES



### TOOLS NEEDED



2960 Amwiler Rd.  
Atlanta, Ga 30360  
dawsonjones.com  
(800) 418-1954  
(770) 458-7234

NOTE: It is recommended that two persons assemble this unit.

1.

## BASE ASSEMBLE

BOTTOM PANEL (x1)  
TOE KICK (x2)  
#10 CAM LOCK (x16)  
BOLT (x4)  
GLID (x4)

1. Connect toe kick panel with bottom panel using bolts.
2. Insert and tighten #10 cam lock.
3. Attach glides to the toe kick.

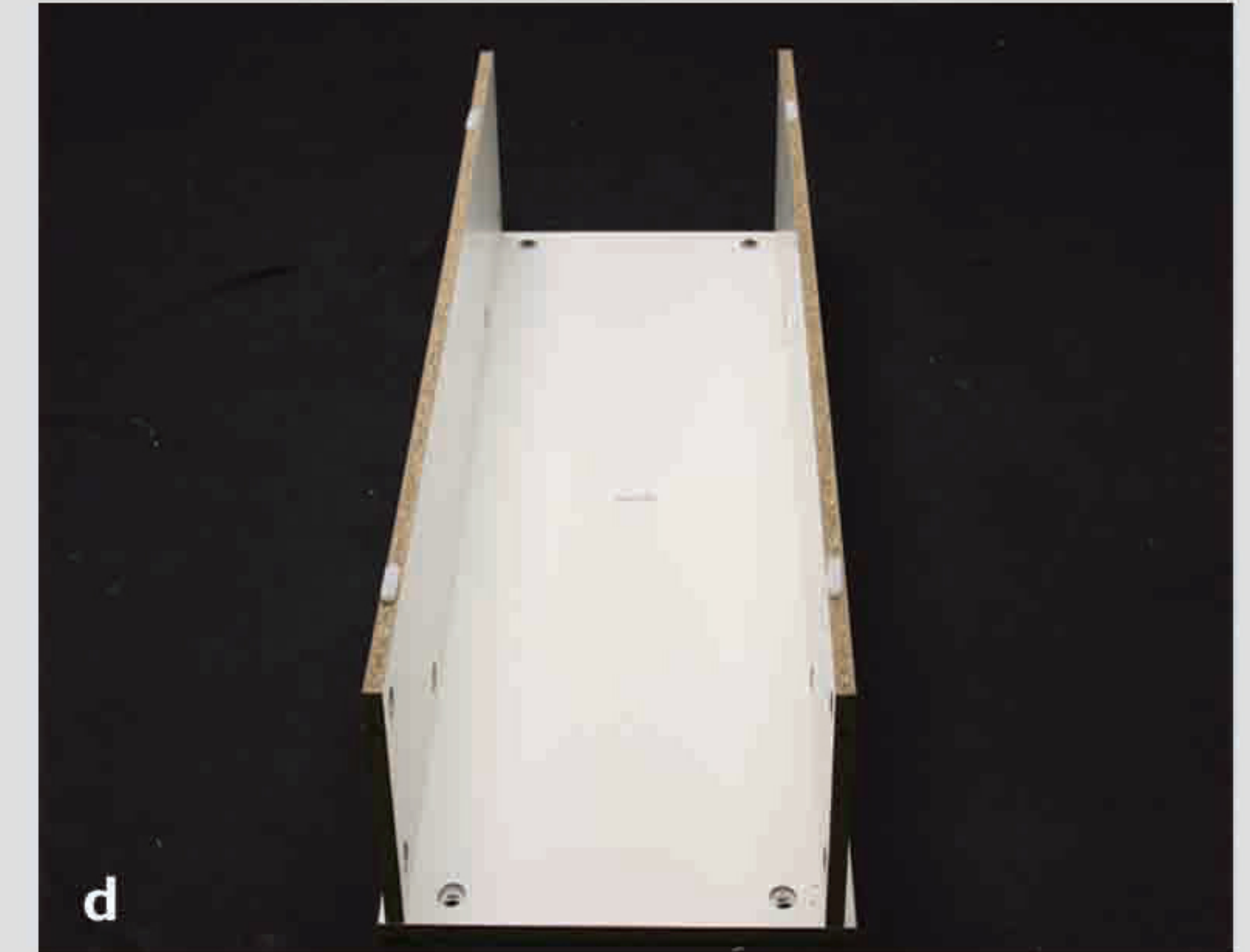
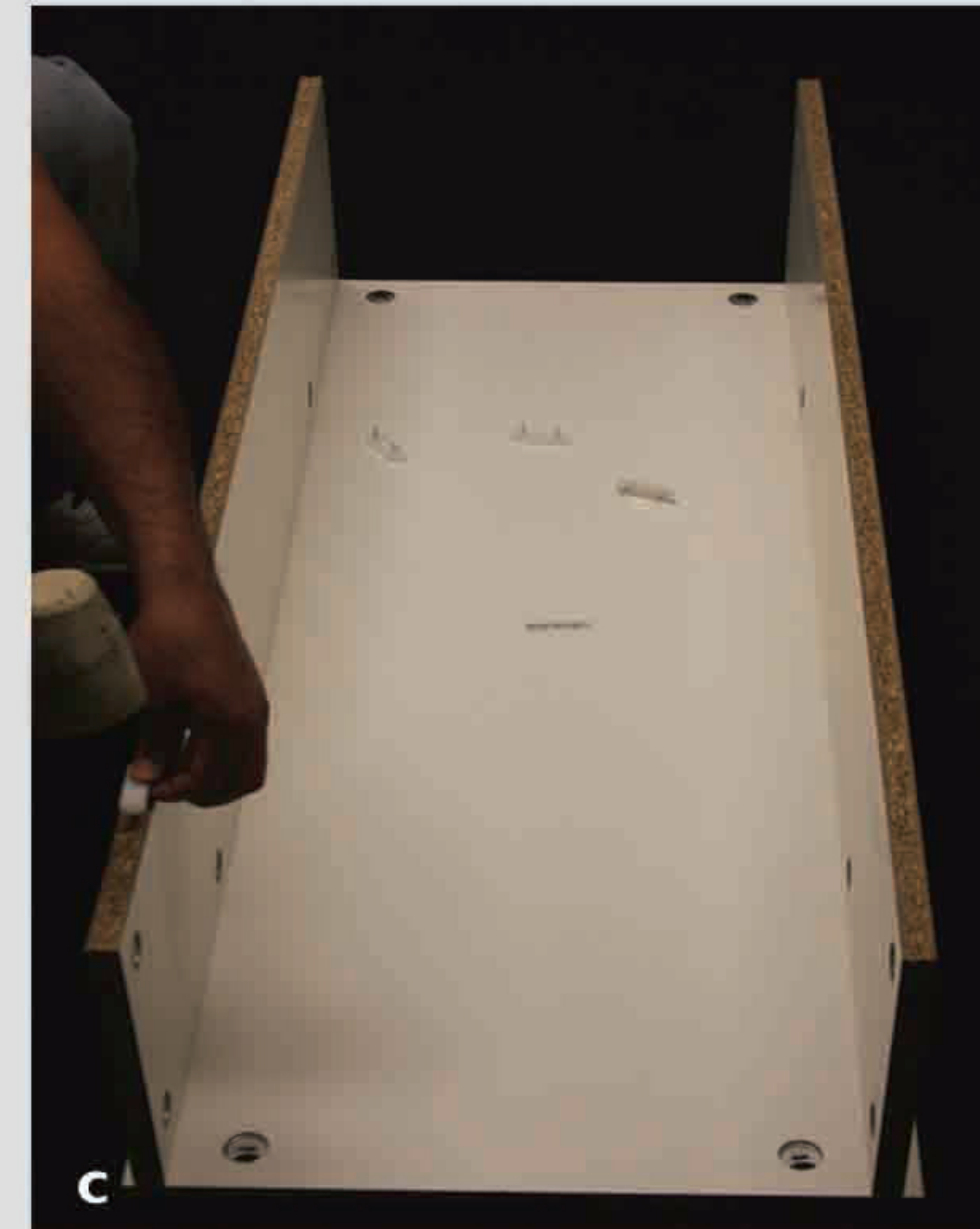
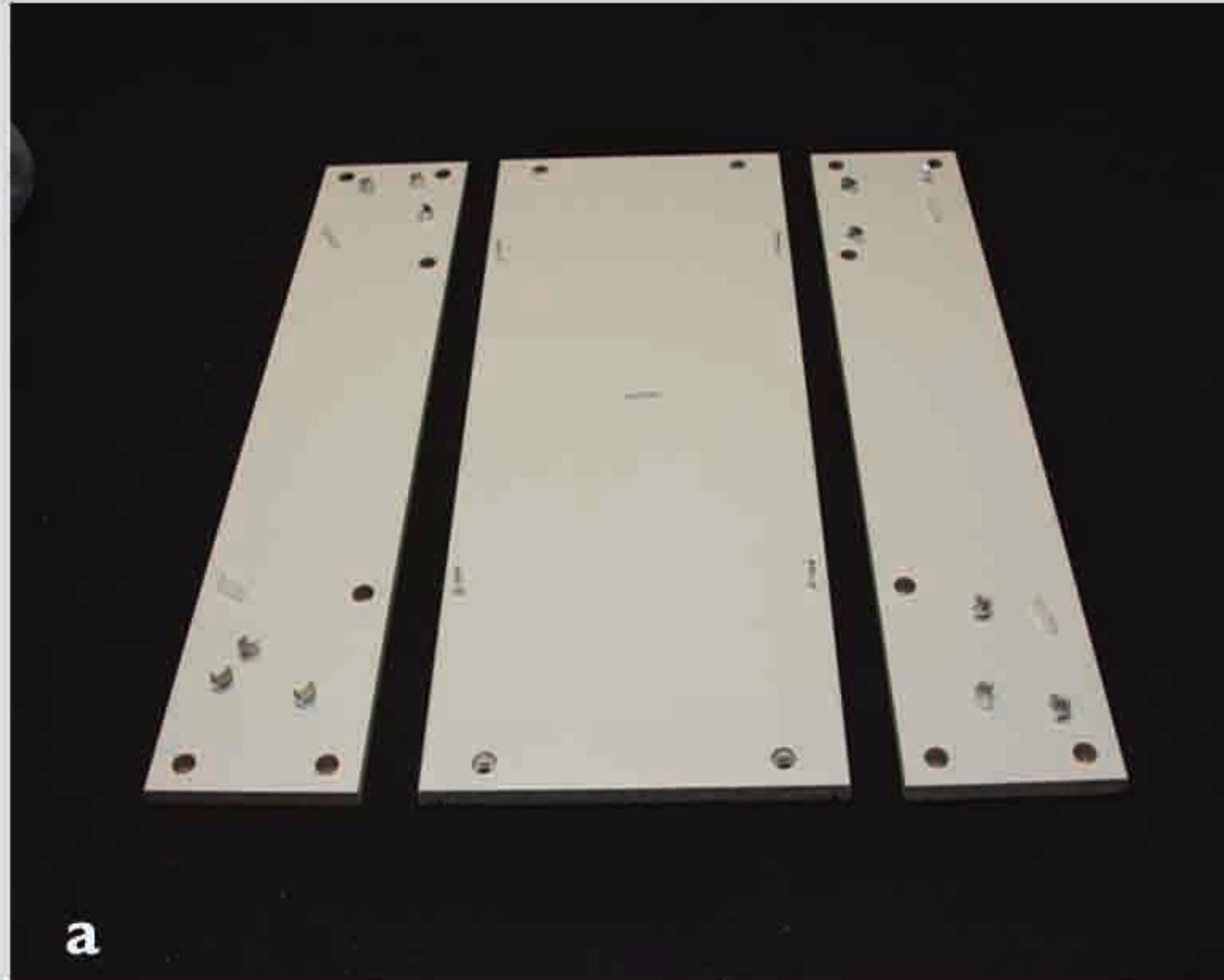

2.

## SIDE PANEL AND FRONT GLASS ASSEMBLE

LEFT SIDE PANEL (x1)  
RIGHT SIDE PANEL (x1)  
BOLT (x12)  
FRONT GLASS (x1)

1. Attach assembled base to right panel; tighten.
2. Insert front glass.
3. Attach left side panel to assembled base; tighten.
4. Sit showcase on floor.



3.

## ALUMINUM EXTRUSION RAIL ASSEMBLE

**U CHANNEL (x6FT) #6 x 158 PHILLIPS SCREW (x6)**  
**AK0312 (x1) FELT (x12FT)**  
**AK0313 (x1) #12 SCREW CAP (x6)**  
**AK0314 (x1)**

1. Attach U channel on top glass, cut off leftover.
2. Attach AK0312 to top glass; tighten by using 2 #6 x 158 phillips screw.
3. Tighten AK0314 with case by using 4 #6 x 158 phillips screw.
4. Put AK0313 onto bottom panel.
5. Adhere felt on both AK0312 and AK0314.
6. Place #12 screw caps onto #6 x 158 phillips screws.

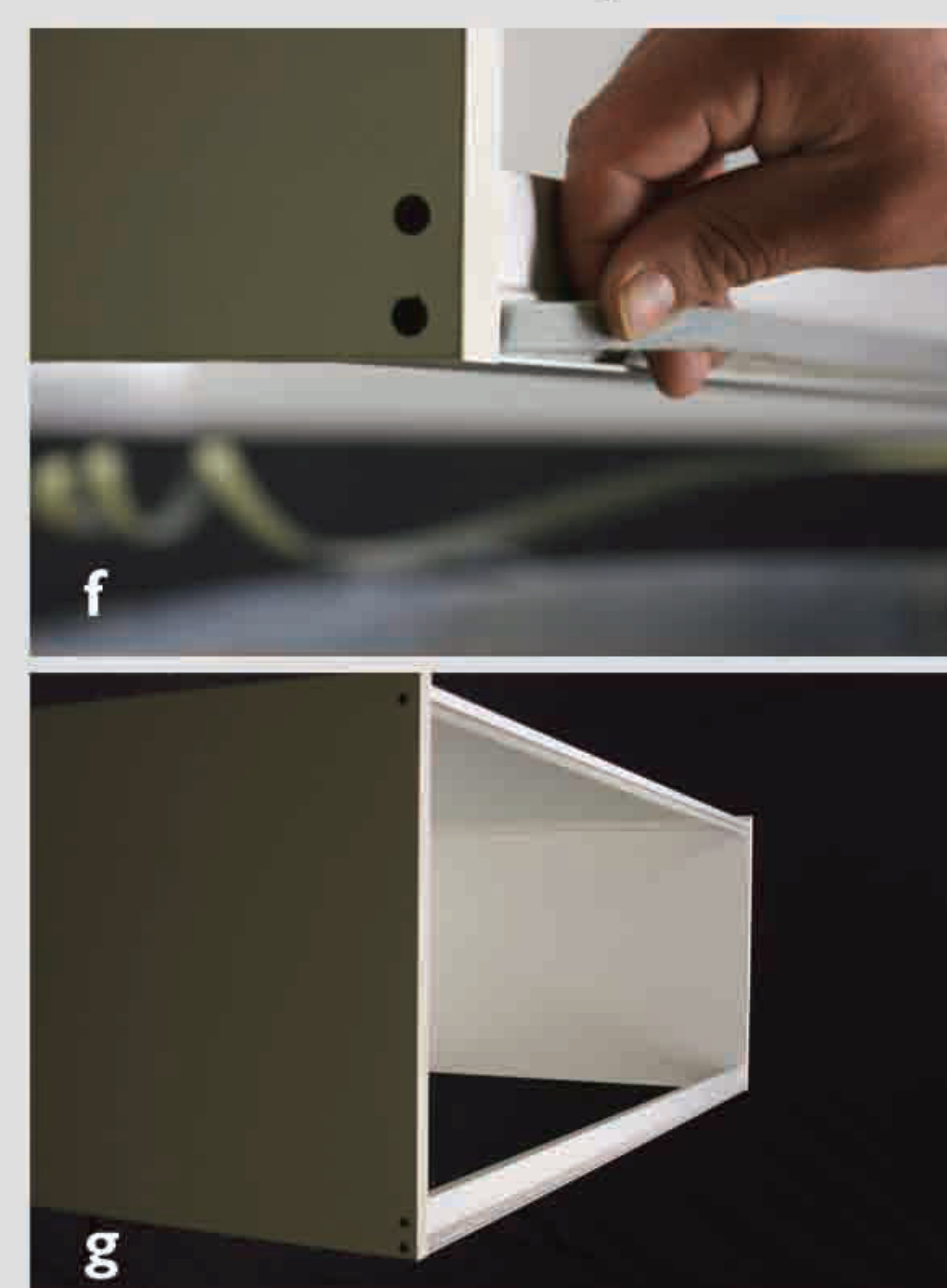
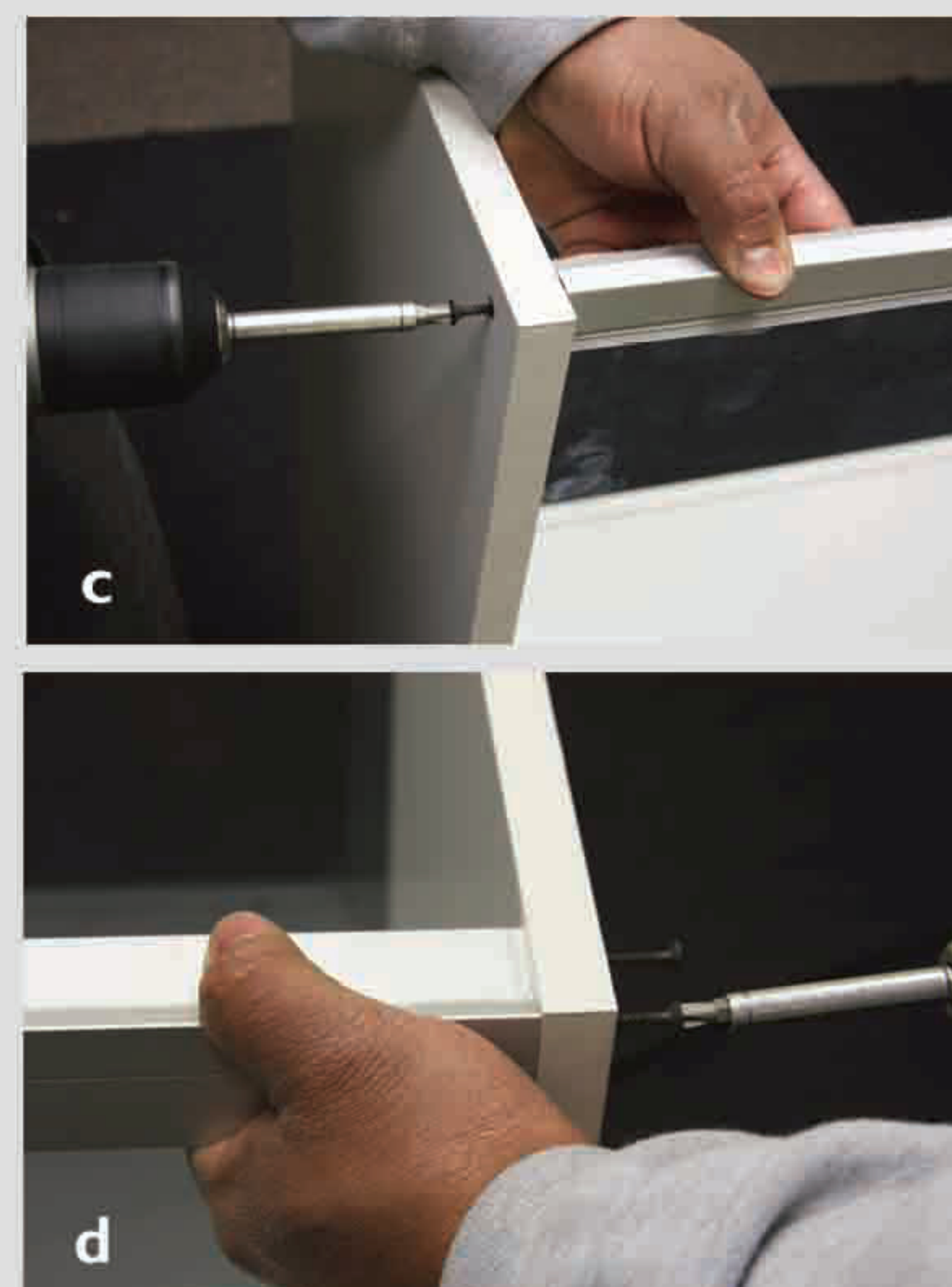
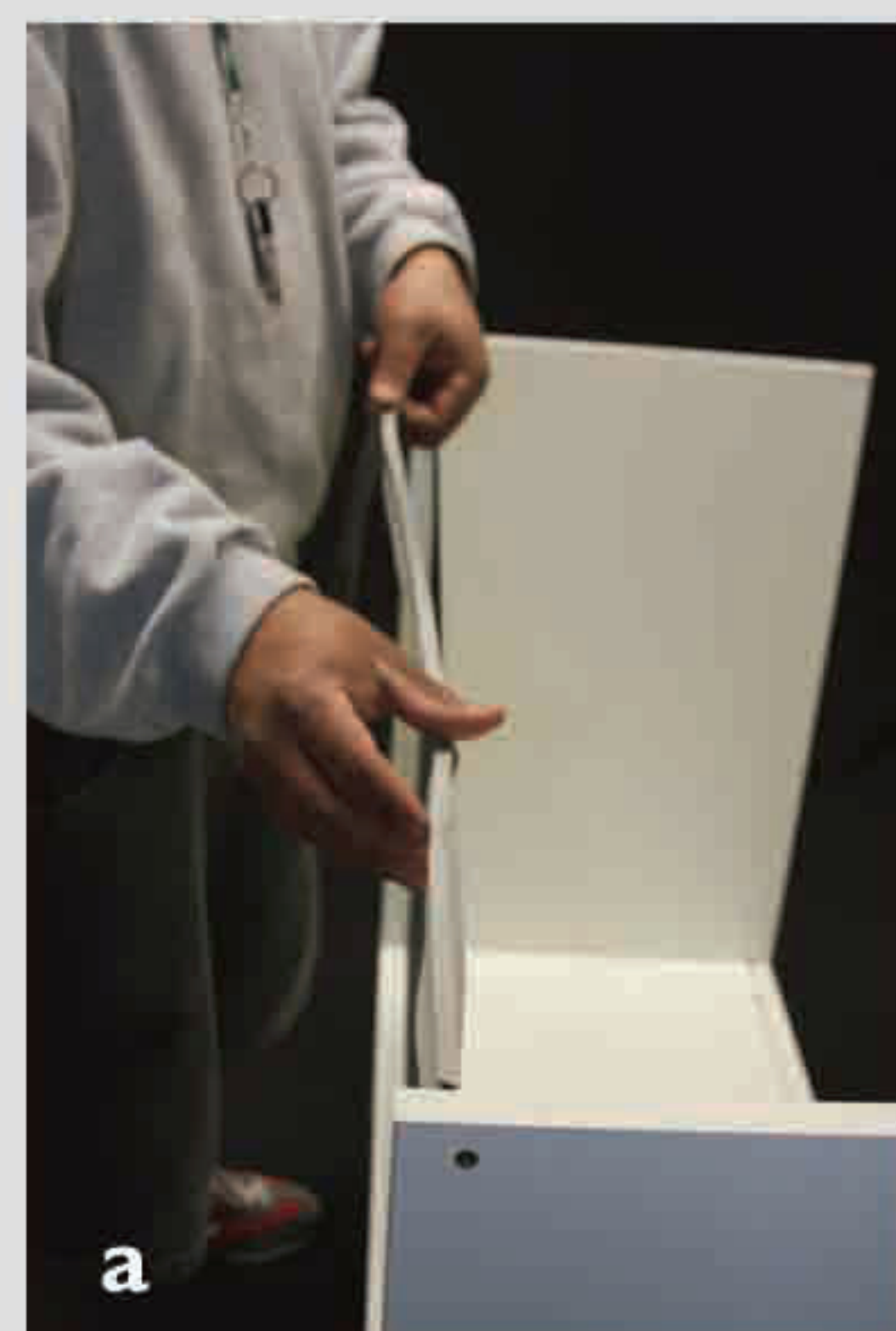

g

h

4.

## STANDARD ASSEMBLE

**SS27CD (x3)**  
**#6 x 34 PHILLIPS SCREW (x3)**  
**#6 x 12 PAN SCREW (x6)**

1. Tighten SS27CD on AK0314 using 1 #6 x 34 phillips screw.
2. Tighten the same SS27CD part on base with 2 #6 x 12 pan screws.
3. Repeat steps 1 & 2 to assemble the other 2 pcs of SS27CD.



5.

## GLASS SHELF & TOP GLASS ASSEMBLE

BT8C (x3)

BT10C (x3)

8" SHELF GLASS (x1)

10" SHELF GLASS (x1)

TOP GLASS (x1)

1. Place BT8C & BT10C on SS27CD with proper height.
2. Place 10" glass shelf on BT10C; put 8" glass shelf on BT8C.
3. Gently sit top glass on the top frame.

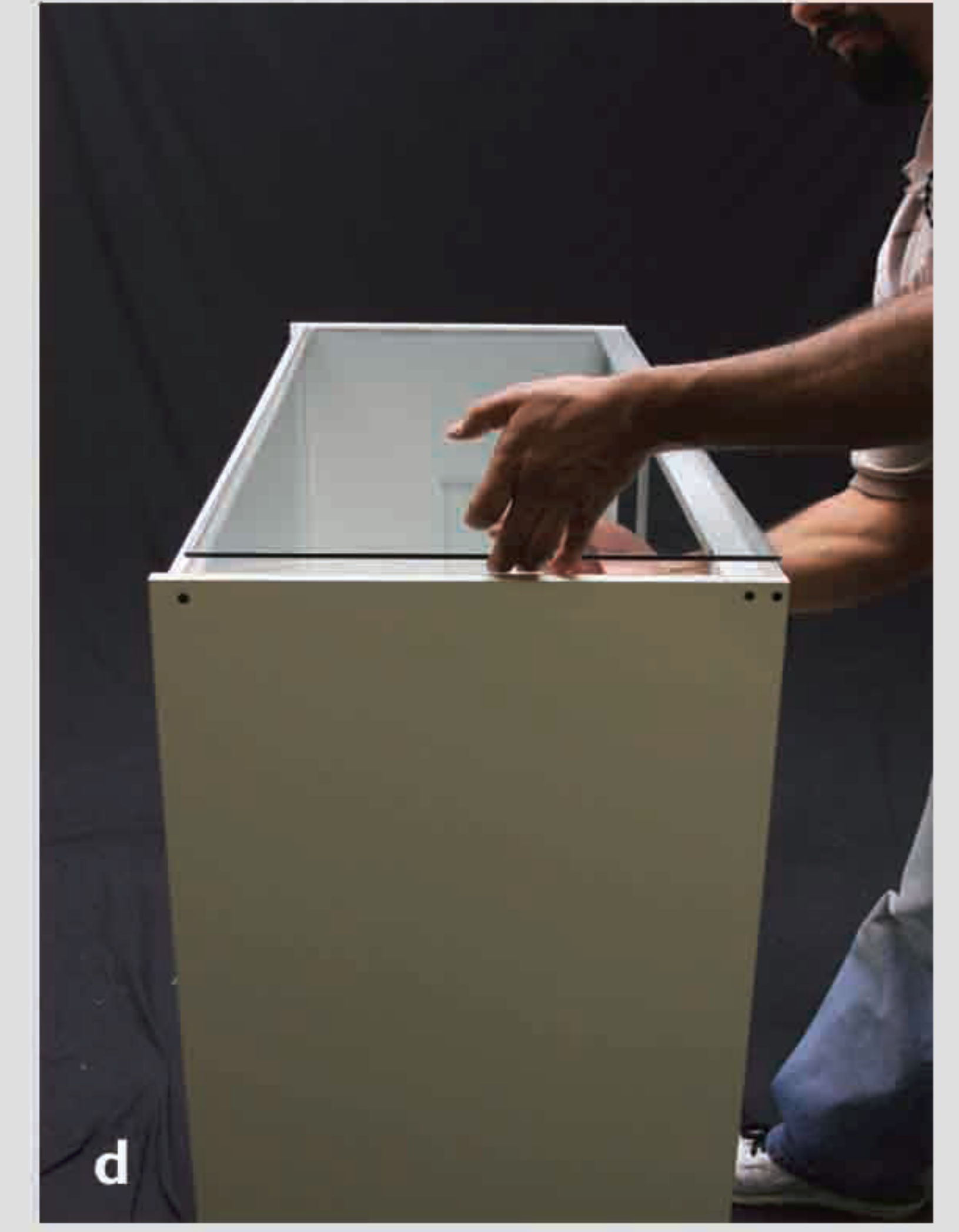
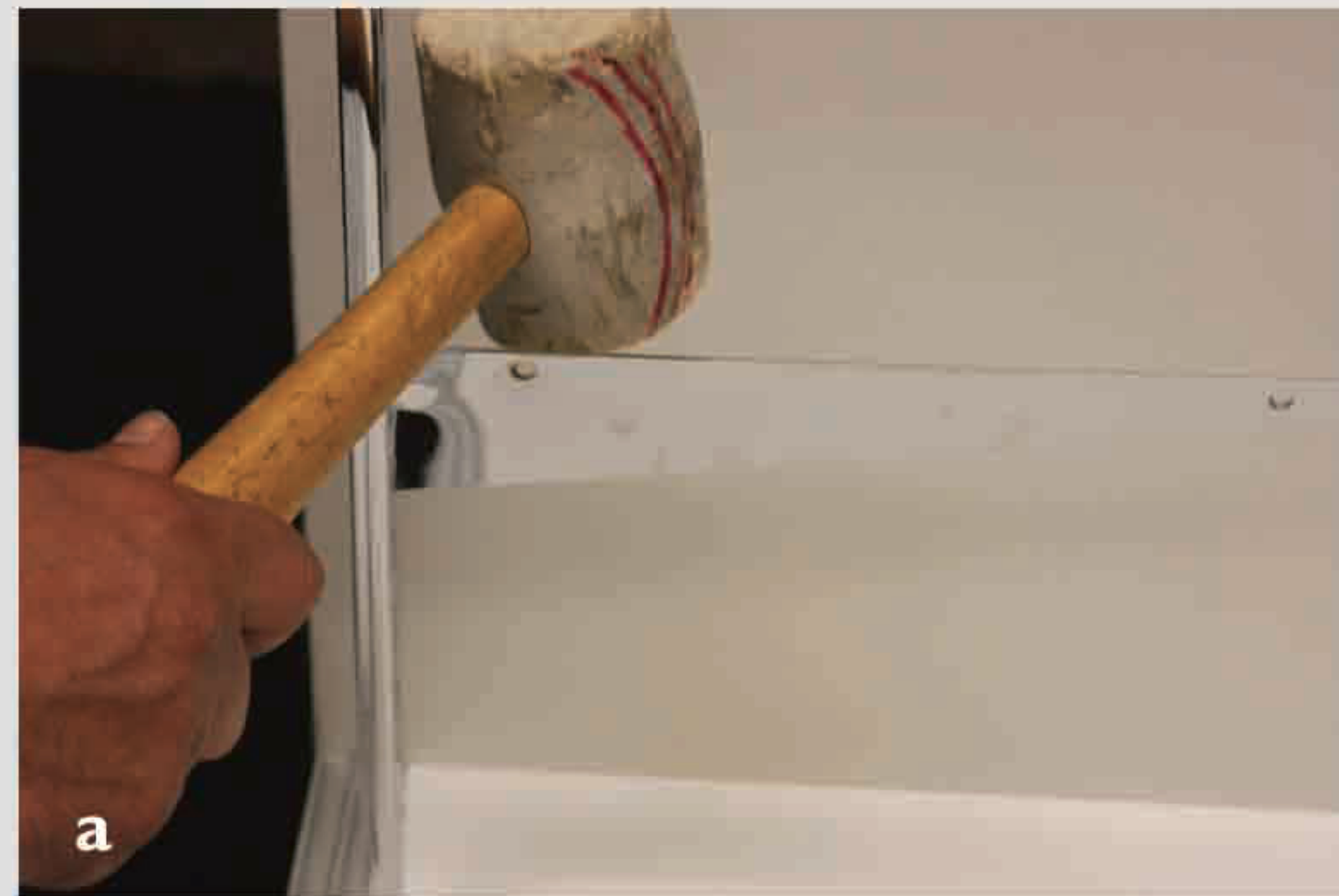

6.

## DOOR PANEL ASSEMBLE

DOOR PANEL (x2)

1. Insert doors on showcase.

